



UTILITY REFRIGERATOR

Project _____
Item No. _____
Model No. _____
Quantity _____

CSI No. 114000

PASS-THRU MILK COOLER/MERCHANDISER

LIGHT BOX WITH 1/8" WHITE PANEL
AND 1/16" CLEAR COVER PANEL
(GRAPHICS BY OTHERS)

PT-R-30-SS-1S-2G-D-C

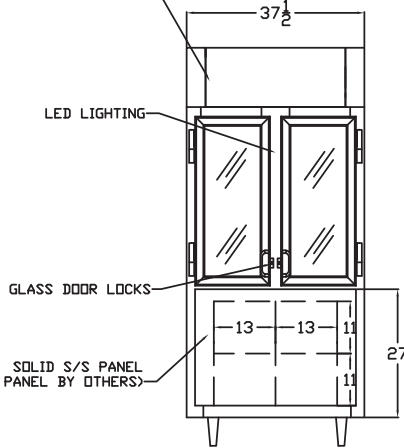

SERVING SIDE

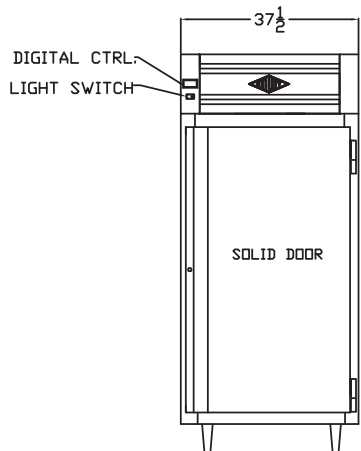

KITCHEN SIDE

MODEL GUIDE

Model Number	Description
<input type="checkbox"/> PT-R-30-SS-1S-2G-D-C	Pass-Thru Refrigerator, 30" Wide, S/S Exterior and Interior

Options	Model Number Modification
<input type="checkbox"/> Remote Refrigeration	Add suffix "X" to model number

AGENCY APPROVALS:



Intertek



Intertek

STANDARD FEATURES:

Construction/Cabinet

- Exterior front and sides – heavy gauge stainless steel
- Exterior back and bottom – heavy gauge galvanized
- Stainless steel compressor housing
- Stainless steel front, door, and grille
- Heavy-duty 6" adjustable stainless steel legs
- Cabinet body is foamed-in-place minimum 2-1/2" thick polyurethane insulation
- Fully coved interior with welded radius corners for easy cleaning
- Interior LED lighting
- Stainless steel shelf clips and shelf standards
- Four adjustable chrome plated wire shelves
- Standard sign panel with clear cover (personalized graphics by others)

Doors

- Self-closing, lift off door hinges with stay-open feature at 120°
- Standard left/right hinged door (other configurations available)
- Full-length, one-piece recessed Unigrip™ door handle (solid door models)
- Heavy-duty, built-in security cylinder door lock (solid door models)
- Energy saving condensate heater around door opening
- Snap-in magnetic door gasket
- Impact-resistant PVC breaker strip

Refrigeration Package

- Expansion valve refrigeration system for superior recovery and temperature pulldown
- Low Pressure control – prevents compressor burnout in case of refrigerant loss
- Top-mounted compressor
- R-290, zero GWP refrigerant for superior temperature recovery and pulldown
- Hot gas condensate evaporator quickly dissipates condensation using zero additional energy
- Integrated sight glass – allows technicians to easily detect leaks or moisture without tools
- Low and high side service ports – for ease of maintenance

Control Systems & Warranty Coverage

- Digital temperature control – easily adjust setpoint between 35-40°F
- Master power switch
- One 9 foot electrical cord
- Warranty: 5 year compressor, 5 year parts, 1 year labor

OPTIONS & ACCESSORIES:

- ☐ Stainless steel top ___ bottom ___ (specify all that apply)
- ☐ Stainless steel wire shelves in lieu of chrome shelves
- ☐ Digital temperature control & solenoid for remote models
- ☐ Refrigerant options for remote models-please specify refrigerant type
- ☐ Stainless steel curb base (specify 4" or 6" high)
- ☐ Temperature alarm
- ☐ 6" front locking casters in lieu of legs (no charge)
- ☐ 4" front locking casters in lieu of legs
- ☐ 6" seismic legs
- ☐ Beverage glides